

ST. NICHOLAS, THANINGTON CANTERBURY, KENT. CT1 3XE

Trail for Children (with accompanying adults)

Answers with explanatory notes are available

YOUR NAME _____ Start the trail at No 1 and Follow the numbers from 1-14.

1 FONT

Find the font. What is put in the font when someone becomes a member of the church?

How many sides has it?

Is it an octagon

or a hexagon?

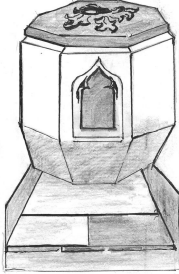

7 ALTAR

The main Altar (Holy Table) is usually under the east window. Mark an **A** on the plan where it is now. Why do you think it has been moved?

.....

.....

.....

2 HALLE BRASS Lady Chapel

Look at the brass memorial on the floor. What animal is lying between the Knight's feet?

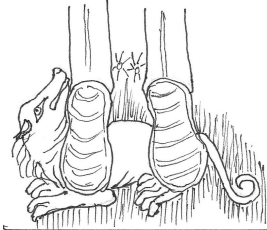

.....

On each corner of the stone slab is a shield showing the Knight's Coat of Arms. How many stars can you find on the shields?

Each star has 7 points, how many points are there altogether?

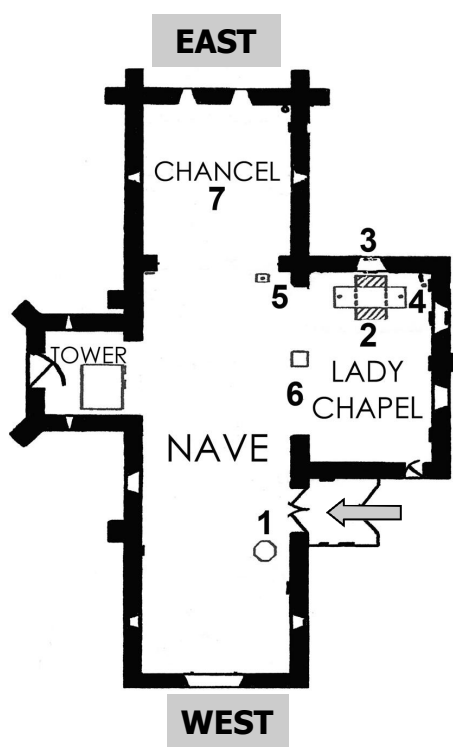

6 CHANCEL ARCH & ARCADE

Look at these two arches

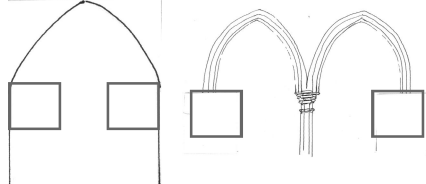

Find the King, Nun, Lady & Bishop. Put **K, N, L, B** in the correct box in the drawings. Draw a head of your choice.



3 EAST WINDOW Lady Chapel

Who is the main figure?

.....

What is the man in the field doing?

.....

How many birds can you see?

On the yellow glass on the left hand side is a Maker's Mark. Who made the window?

.....

Where was it made?

.....

When was it made?

.....

4 PISCINA

Now look on the south wall and find the Piscina set in the wall. This was used for HOLY WASHING UP!

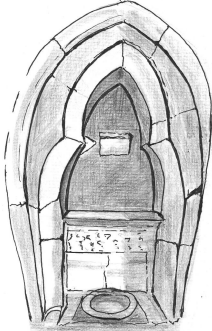

Does it have a drain-hole?
Yes/No

Does it have a shelf?
Yes/No

5 LECTERN

Find the Lectern (book-stand). Mark an **L** on the plan.

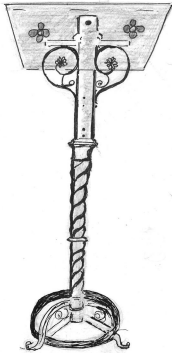

What is the metal?
.....

Is there a book on the stand? Yes/No

What is it called?
.....

8 EAST WINDOW

On the wooden panel below the East window is a crucifix (a cross with a figure on it). The cross is the main Christian sign. Who is hanging on the Cross?

Find the same image in the window and mark an **X** by the correct roundel.

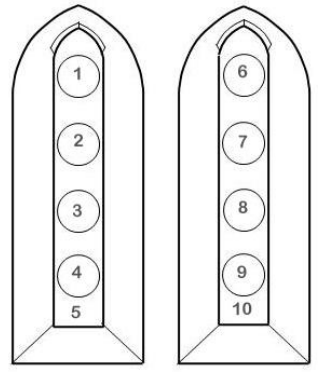

EAST

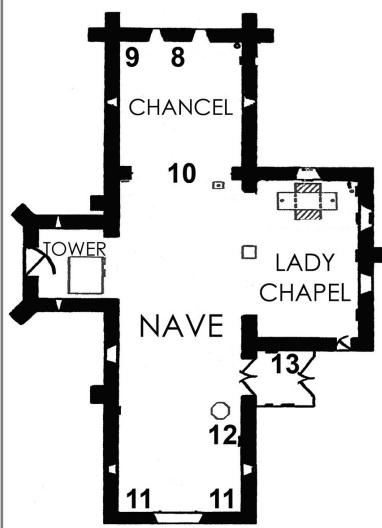

9 SAINT NICHOLAS

The church is dedicated to Saint Nicholas who is the patron saint of children, sailors and travellers. Find his statue and draw him.

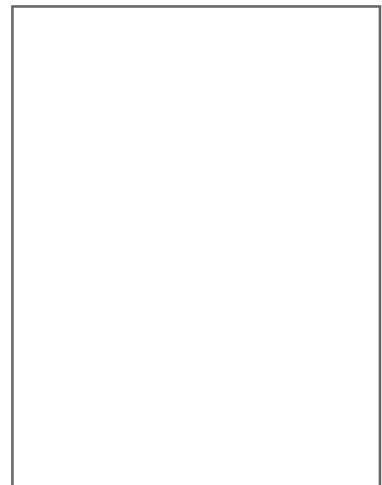

10 KNEELERS

In front of the Altar rail are some red kneelers. Why are they here?

.....

There are symbols and a cross on each kneeler. The symbols are Greek for Alpha & Omega which means 'I am the beginning and the end'. Draw the symbols.



11 INCUMBENTS' (VICAR'S) BOARD

The three large boards at the back of the Nave shows a list of the names of all the past Vicars. What is the Name of the 1st Incumbent?

When was he there?
 Who was on the throne at the time?

Look at the shield at the top right hand side. This is the Coat of Arms of the Diocese of Canterbury and is used by each Archbishop, as head of the Church of England.



12 THOMAS COOPER MEMORIAL

Look at the memorial high up on the south wall. There are 8 *very small* carved heads towards the top of the memorial. How many can **you** find?



When did Thomas Cooper die?

How old was he when he died?

Who else is mentioned?

In which years did they die?

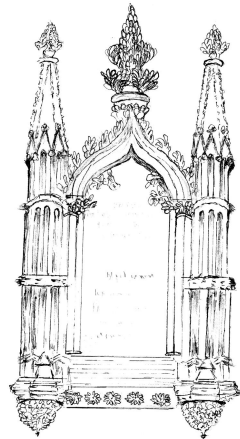

13 WAR MEMORIALS—Porch

There are three War Memorial boards in the porch. What was presented to the church in 1949 in memory of those men killed in the Second World War?

Where was L/CPL Anthony Cork killed and when?

How many people were killed in all three wars?



14

What did you like best in the church? Write down what it is and why you like it.

.....
