

ST PETER, BRIDGE, KENT, CT4 5AR

Trail for children (of all ages!)

Explanatory notes and answers are available for accompanying adults



YOUR NAME

Start the trail at the font **No1** then follow the numbers through to **No 14**

1 FONT

The font is used for BAPTISM/CHRISTENING when someone is made a member of the church. What is put in the font for Baptism?

Why is there a hole in the basin?

The outside is OCTAGON shaped. How many sides are there?

Look for the fossils in the base.

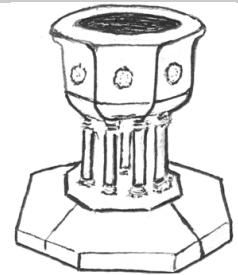

2 LADY CHAPEL window

Who made the window?

Where was it made ?

When was it made?

3 WHEEL WINDOW

Why do you think this is called a 'Wheel' window?

Draw it.

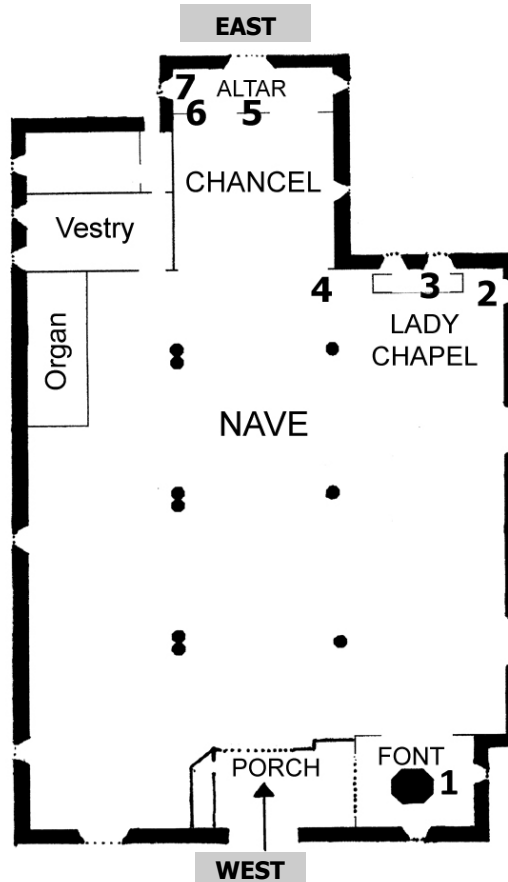
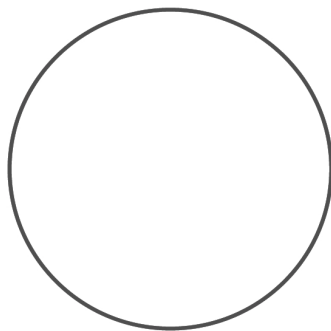

7 SKULL & CROSSBONES

Look for a skull and Crossbones. Why do you think there is a spade and pickaxe?



Look high up on the south wall. Find another skull, mark an **S** on the plan. Where else could you see this sign other than in a church.

6 HERALDRY

Find the large kneeler behind the altar rail. The 'Hat' is called a MITRE.

Who would wear it?

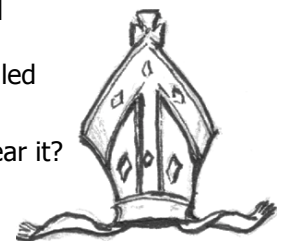

Heraldry has its own language eg: **Azure**, blue; **Gules**, red; **Sable**, black; **Or**, gold.

4 PULPIT

Go to the pulpit. Mark it with a **P** on the plan. The Vicar or preacher usually stands here to talk to the congregation (people). Do you know why?

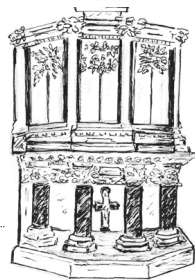

Draw your favourite motif from the carvings on the panels.



5 ALTAR

Why is there a cross on the altar?

What is it made from ?

Who is carrying the cross in the East window?

Look for another cross nearby. Mark an **X** on the plan.

Colour this Coat of Arms.

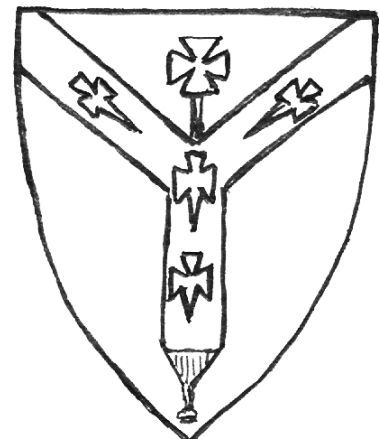

8 TYMPANUM

Find this carving. Look for Adam and Eve and the Serpent (snake). Tick the box where they appear, in the drawing below. What shape is the tympanum?

What is it made from?



Find an Angel, what is he holding in his hand?

.....

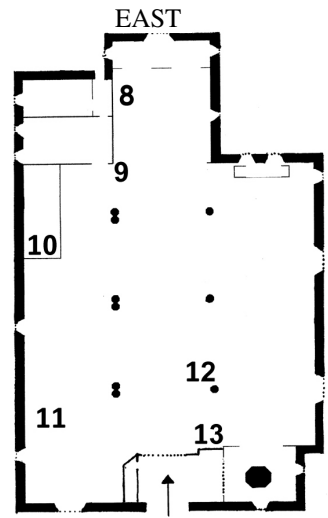

9 LECTERN

Find the lectern with a brass stand. Mark it on the large plan with an **L**. The Holy Bible is always kept on one side of the double desk lectern. Is there a book on the second side?

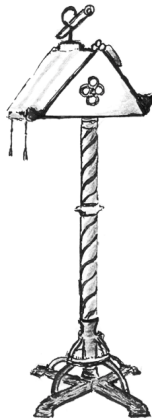

If so, what is its title?

10 ORGAN

How many pipes can you see?

Will the longest or shortest pipe make the lowest sound?

Why is there a mirror?

Write the name of another organ stop.

ORGAN STOP



11 MEMORIAL PLAQUE

Memorials remember people who have died. Look high up on the wall in the north aisle. Find a white plaque and mark **M** on the plan.



What is the name of the person?

Look for a window of the same shape as the plaque.

Which wall is it on?
To whom is it dedicated (named)?

When did he die?

12 CHURCHWARDEN'S WAND

There is a wooden pole fixed on the side of one of the benches in the nave. The brass finial (or top) is shaped as a Canterbury Cross.

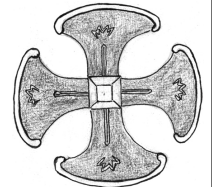

How is it different from the other crosses you have seen?

14 WINDOWS

Walk around and look at all the windows. Which is your favourite? Mark it on the plan with a **'W'**. Why do you like it best?

13 CARVING

When you are facing the glass porch door, look up at the arch to the left. Look for an animal like face. What do you think it is?



We hope you have enjoyed your visit to St. Peter's Church and that you will come again.

St. Peter, Bridge in the Diocese of Canterbury. High Street, Bridge, CT4 5AR